

DRAFT AGENDA USCL Board of Trustees and Leadership Team

Meeting April 25, 2022

6:30 pm Zoom On-Line Meeting Agenda

Meeting ID: 177 417 886 Passcode: 601744 Board

Board Members: Dan Maynard, Kathleen Assiff, Jane Cloos, Casey Millar, Chrissie Shearer, Lucille Olson, Teresa Mulford, Sharon Ketchum (non-voting)

Leadership Team: Jerry Podany (Admin and Project Management), Nanette Podany (Kitchen) Sue Winklestern (Design Report in Agenda)

ABSENT Jeff English (Celebration), Danielle McMahon (SAGE)

Call meeting to order: Dan

Pray in: Rev. Sharon

Reaffirm mission and vision statements Dan

Mission: Spiritual awakening to our Oneness with God, with each other and with all creation.

Vision: A world powerfully transformed through a growing movement of shared spiritual awakening.

1. **Acceptance of agenda**
2. **Approve Minutes from March 28th meeting:**
3. **Recording of E-votes for the Record –**
April 6th E-Vote on Approval of revised Renovation Budget for electrician
Dan made a Motion to approve hiring Osbourne Electric to do then necessary electrical work on the ADA bathroom and office renovation in the Lodge for \$3500. Jane, Teresa, Kathy, Chrissie, Lucille, Casey passed

7:00 pm Treasurer's Report Jane

See Treasurer's Separate Reports emailed out

Operational Income and Expenses for MARCH 2022

	Mar 2022	Mar 2021	YTD 2022	YTD 2022 Budget	YTD 2021
Income	\$ 23,-985.88	\$10,705.88	\$52,310.25	\$36,824.98	\$43,027.11
Expenses	\$ 14,971.19	\$11,487.06	\$41,192.75	\$39,393.50	\$32.991.58
Net Ordinary Inc	\$ 9,014.69	< \$781.18>	`\$8962.81	< \$2,568.52>	\$10.035.53
Other Income	\$0	\$41,196.35			
Other Expenses	\$ 4,281.84	\$27,015.08			
	Mar 2022	Mar 2021	YTD 2022	YTD 2022 Budget	YTD 2021
Net TOTAL Income	\$4,996.70	\$13,400.09	\$50,748.16	<\$ 2,568.52>	<\$10,146.14>

Notification that Jane will be inputting the tithes for March for UWM and UWSI – they were made but not recorded. \$485.52 X 2 so final report for March will reflect this change.

Notes: Kitchen: vent fans need repair, as well as repairing ovens, ice maker

Extraordinary Items in March - \$15,000 gift

Follow-up on Solar: Jessica has contacted 5 solar companies and arranging for quotes. This will take awhile as they take time to respond and schedule visits to the property. Have reached out to Marshall Clabeaux, Coop Development & Engagement Coordinator for MI Energy Transition for some direction on solar. Chrissie to check with solar energy lobby. Sue W. just installed will solar and will share her information. **Chrissie and Sue to email UnityLansing.org with their info.**

Old Business

1. **Text Donations** – Decided to go with QR

See Jane's cost comparison.

Note: QR code now on all tables so people can donate easily by phone.

SHARON: Add QR code to website on donation page as well as PowerPoint.

Event Rental Venue Update – see attached – Decisions tabled till next Board Meeting

1. Met with South Lansing Farmers Market and ASPPIRE April 21. May get some small rental events with them.
2. Jessica has a number of quotes out in response to inquiries
3. Cannot advertise but can respond to individual inquiries for private events, weddings etc., be careful renting to "for profits"
4. Only thing on sign is weddings, funerals, etc. – events which are usually acknowledged as " church " activities

FYI: Events currently booked:

Both Events for May cancelled: May 1 Memorial for Shields family, May 14 Lansing Area Aids Network

June 4th McMahan wedding tea, June 11th at 2 pm Ellie Grieb Memorial, June 25th Casey & Ben wedding at 3 pm

Ministry Teams reports: (Alphabetically) – Items for discussion/motions

Admin Team - Building:

Update on Renovation of Lodge to receive occupancy permit. – Jerry
Plumbing and Electrical rough-in's complete. Passed Plumbing Inspection. Electrical Inspection Tuesday, Apr. 26th

Building FYI: Trash -Currently sharing cost with Steve (we pay \$55/month, Steve \$20)
If we wanted trash pickup instead of a dumpster –
\$26.60/month per Trash can for weekly service, Recycling \$14.10/month for biweekly.

Celebration Team: Baby Grand piano was repaired, broke again Jeff (absent)
Piano Technician Tim's Precision Piano. \$65/service call. Jerry is working on recreating the broken piece (\$400-\$500 savings) week of May 1st. Then Tim will come back and reinstall it

Design Team – Meeting May 1st to determine colors for Lodge floors, paint, countertop. Also Prayer Room, and consider what can be done to make it easy to find the Activity Room.

IDEA (Diversity) Team –

Teresa

May – Asian Pacific Islander month, June Pride month

Outreach and Social: (*Team is not currently active but subteams are*)

Fellowship is again serving beverages and snacks;

Nanette and Chris

Lunch Bunch meets again May

Nancy Claytor & Lisa Haston

Library is open

Lisa Schmidt

SAGE Courageous Conversations

Dan and Danielle McMahon

National Association of Social Workers Michigan approved our program for CE credit.

Update on Saturday, April 23rd event

SILENT PRAYER TEAM – no report

Sharon

TECH TEAM: Sunday, March 27th was video training.

Greg Dening

FYI Videos of training sessions available

Inactive Teams - FYI

Nominating Team 2023 (*inactive till November*) Karla Janing and Jerry Podany – No Report

Unity Earthcare – Team inactive but Styrofoam (Sybil Spencer and Lisa Schmidt), Batteries and Pop tabs still being collected

Youth and Family – Inactive

Ministers Report: covered in Team Reports Below are FYI's

Easter Service attendance: Sunrise: 14, Breakfast 17, SALT – 12?, Sunday Service 45

Memorial Service for Liam, Saturday April 30th 1:00 pm – wear red

Everyone is invited to Casey's wedding June 25th, Tea Shower June 4th

Minister's Schedule: Week of April 24th, UWM ZOOM board meeting Apr 26-28th

Off During May 23 – June 3rd as my daughter visits from New Zealand.

Away to Unity Convention in Kansas City June 12 – 17

(Casey left meeting)

New Business

Policy of Memorial Meditation Garden for planting of trees

1. Dan made Motion approve Meditation Memorial Garden space: unanimous - passed

Start of Meditation Memorial Garden – Sharon to approach, Peggy, Lee, and two landscapers

Jerry to mark area and make stakes to mark boundaries

2. Lucille made a motion, seconded by Kathy, that all people planting trees have the approved plaque, ordered by Unity. Plaque must include name of tree and can include 'in memory of' and a person's name. (Note: no epitaph)

Jane on vacation the next two Sunday – Dan, Jane and Lucille away. Chrissie will sign.

Adjourn meeting –

**Memorial Meditation Garden
Southeast Corner of Property**

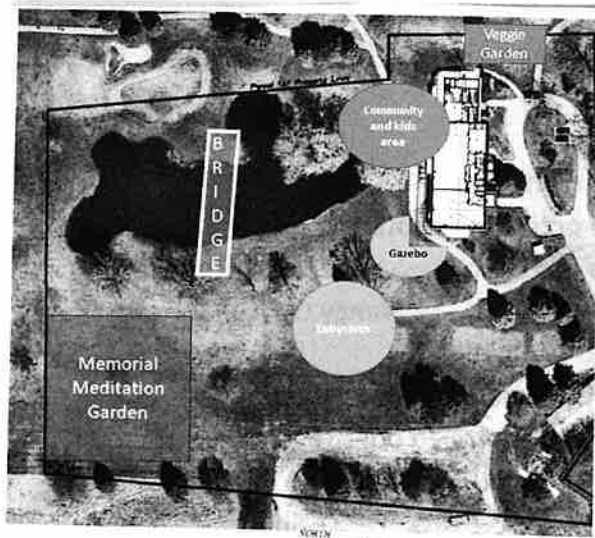

Planting a Tree in honor/memory of a person, pet or cause

If a congregant would like to plant a tree in honor or memory of a loved one (person or pet) or a cause:

1. TREE

- a. In order to support the trees in thriving, we ask that tree choices be made from Unity's overall plan for the garden. (Trees do best next to trees like them.)
- b. Tree is purchased by donor. Planting is the responsibility of the donor.
- c. Tree is either planted by donor in designated location or donor makes arrangements with a nursery/gardener to plant the tree.
- d. Unity will be responsible for watering.

2. PLAQUE

Plaque: Amazon 4" by 6" \$34.99

Unity will order plaque. Donor will designate content.

Sign can include "in memory of" but no epitaph

Engraved – to include name of tree



- **SOLID METAL:** Made for indoor-outdoor use. Label plants, trees, fruits, vegetables or flowers in your garden with this elegant metal sign. These signs make great dedications and memorials for a loved one.
- **CUSTOMIZABLE:** Include your personal text over multiple lines.
- **LASER ENGRAVED:** Our laser-engraving process fuses a dark

- **gray/black text to the surface of the material**
- **OUTDOOR USE:** Both stainless steel and titanium are made for outdoor use with no upkeep. Copper, Brass and Bronze will need periodic cleaning as they will tarnish.
- **MADE IN THE USA:** Proudly designed, produced and made in America. Local materials are sourced and used when available.
-

CREMAINS PLANTED WITH TREE – unofficial

Not in a container. Can be planted or sprinkled

DIRECT TITHE COMPARISONS

Direct Tithe Options

Vendor Options	Current Vendor: <u>Paypal</u>	<u>EveryWare</u>	<u>Tithe.ly</u>	<u>Continue to Give - Free</u>	<u>Continue to Give - Gold</u>
Website	paypal.com	everyware.com	get.tithe.ly.com	continue2give.com	continue2give.com
Monthly Fee	\$0	\$39	\$19 (for text-to-give?)	Supported by Tips	\$29
Transactions Fees:					
Visa/MC/Discovery	1.99% + \$0.49	2.9% + \$0.30	2.9% + \$0.30	3.2% + \$0.45	2.7% + \$0.25
AmEx	??	2.9% + \$0.30	3.5% + \$0.30		
ACH/Bank	1.99% + \$0.49	2.9% + \$0.30	1% + \$0.30	\$5/mo + 0.5% + \$0.30	\$5/mo + 0.5% + \$0.30
Text-to-Give	n/a	\$0.02	\$19/mo + \$0.029/ea x 200	\$10/mo	\$10/mo
QR Code	1.99% + \$0.49	n/a	n/a	??	??
Church Mgmt System (ChMS)	??	included	\$49/mo + \$149 setup fee	\$46/mo, no setup fee	\$46/mo, no setup fee
Actuals via Paypal:					
Gross 2021 Income via Paypal	25,227.14	Jan-Mar 2022	6,570.90		
Less Paypal Fees (93 transactions)	547.59	Less Paypal Fees (40)	135.57		
Net Paypal Income	24,679.55	Net Paypal Income	6,435.33		
Best Options are Highlighted					
PROJECTIONS	<u>Paypal - Actuals</u>	<u>EveryWare</u>	<u>Tithe.ly</u>	<u>Continue to Give - Free</u>	<u>Continue to Give - Gold</u>
Gross 2021 Income via Paypal	25,227.14	25,227.14	25,227.14	25,227.14	25,227.14
Transaction Fee Estimates (@ 93)	45.57	27.90	27.90	41.65	23.25
Percentage Fee Estimates	502.02	731.59	731.59	807.27	681.13
Monthly Cost Estimates	-	39.00	19.00	20.00	29.00
Total Fees	547.59	798.49	778.49	869.12	733.38

Gross 2021 Income via Paypal	25,227.14	Jan-Mar 2022	6,570.90		
Less Paypal Fees (93 transactions)	547.59	Less Paypal Fees (40)	135.57		
Net Paypal Income	24,679.55	Net Paypal Income	6,435.33		
Best Options are Highlighted					
PROJECTIONS	<u>Paypal - Actuals</u>	<u>EveryWare</u>	<u>Tithe.ly</u>	<u>Continue to Give - Free</u>	<u>Continue to Give - Gold</u>
Gross 2021 Income via Paypal	25,227.14	25,227.14	25,227.14	25,227.14	25,227.14
Transaction Fee Estimates (@ 93)	45.57	27.90	27.90	41.65	23.25
Percentage Fee Estimates	502.02	731.59	731.59	807.27	681.13
Monthly Cost Estimates	-	39.00	19.00	20.00	29.00
Total Fees	547.59	798.49	778.49	869.12	733.38
+(-) fee variance to PayPal		250.90	230.90	321.53	185.79
Annualized Projections by Amt - Net Income After Fees					
	<u>Paypal - Actuals</u>	<u>EveryWare</u>	<u>Tithe.ly</u>	<u>Continue to Give - Free</u>	<u>Continue to Give - Gold</u>
\$25 donations - 52	1,248.52	1,246.70	1,246.70	1,235.00	1,251.90
\$35 donations - 26	884.26	875.81	875.81	869.18	878.93
\$50 donations - 26	6,474.26	6,303.70	6,303.70	6,280.30	6,318.00
\$400 donations - 13	6,384.16	6,209.60	6,209.60	6,188.00	6,223.20
\$50 donations - 12	588.12	579.00	579.00	575.40	580.80
\$350 donations - 12	4,188.12	4,074.60	4,074.60	4,060.20	4,083.60
	19,767.44	19,289.41	19,289.41	19,208.08	19,336.43
+(-) income variance to PayPal		(478.03)	(478.03)	(559.36)	(431.01)